

DETTAGLIO C



DETTAGLIO D



DETTAGLIO E

SEZIONE A-A

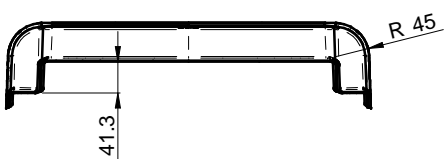
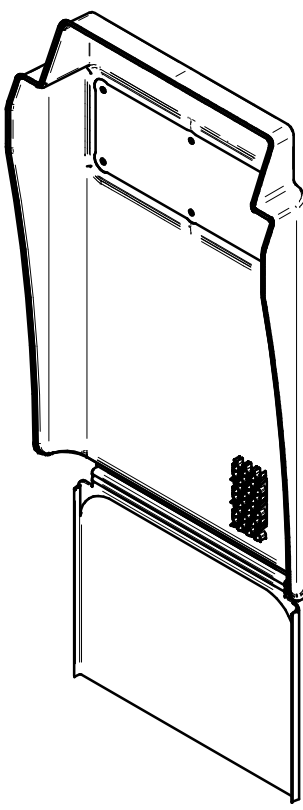
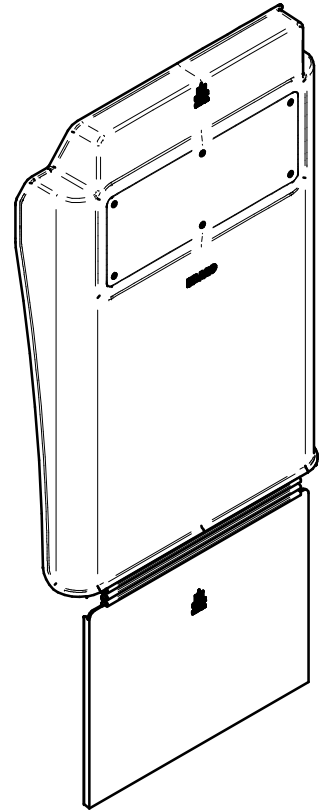

ACCURACY				REVIEW		DATE	DESCRIPTION	DRAFTSMAN			
LINEAR DIMENSIONS				N°2	01-08-2019	Riduzione spessore del pezzo (-1MM) tramite abbassamento della linea di chiusura dello stampo.	<b>Guglielmo C.</b>				
±0.1	from 6 to 30	±0.2	from 30 to 120	±0.3	from 120 to 315	±0.5		N°1	08-02-2017	Aggiunta spessore (nervatura) di rinforzo sopra la cerniera per contrastare la deformazione del pezzo (studio 1702081)	<b>Manuel Pillan</b>
±0.8	from 315 to 1000	±1.2	from 1000 to 2000	±2.0	from 2000 to 4000	±3.0		N°1	24-01-2017	Portato i 6 fori a 8,5mm e tolti gli esagoni di antigiro	<b>Manuel Pillan</b>
ANGULAR DIMENSIONS				MATERIAL		TREATMENT	DRAFTSMAN				
±1°	to 6	±30'	from 30 to 120	±20'	from 120	±10'	<b>Manuel Pillan</b>				
LAGO				SCALE	CREATION DATE	SET					
Lago Accessori srl				1 : 10	21/12/2016	DRAWING CODE					
via 1°Maggio 20, 35014 Fontaniva (Pd) Italy				SHEET		156040025.par					
Tel: +39 049 5940932 Fax: +39 049 5940599				1/1		DESCRIPTION					
www.lagoaccessori.net info@lagoaccessori.net				CODE AND DESCRIPTION OF FINISHED PRODUCT							