

PART NUMBER DESCRIPTION	ITEM 1 BASE LATCH (QTY)	ITEM 2 RIVET (QTY)	ITEM 3 LEVER (QTY)	ITEM 4 WASHER (QTY)	⑧ PART MARKING
11447-16 050-0100, LH, 2 POSN, .286, FGR RLSE	0500100-62 (1)	80635-16 (1)	80645-15 (1)	80950-15 (1)	11447

REVISION	ECN	ECN BY	DESCRIPTION
7	21572	GDE 01/08/08	80853 (QTY 1) WAS (QTY 2), 4X (Ø .286) WAS 4X Ø .286 THRU. ADDED: 19427-01 (ITEM 13). HEX/TRI/VALENT UPDATES. UPDATED TO NEW FORMAT.
8	36200	AGG 08/30/11	UPDATE: NOTE 1, FORMAT, DESCRIPTION; PART MARKG; ADDED: ISO VIEW. ADDED: ISO VIEW, NOTES 7, 8.
9	37941	AGJ 07/30/12	CONVERTED TO BASE LATCH, UPDATE: FORMAT (D TO C), CR/PR DIMS, ISO VIEW, REMOVED: NOTE 7.

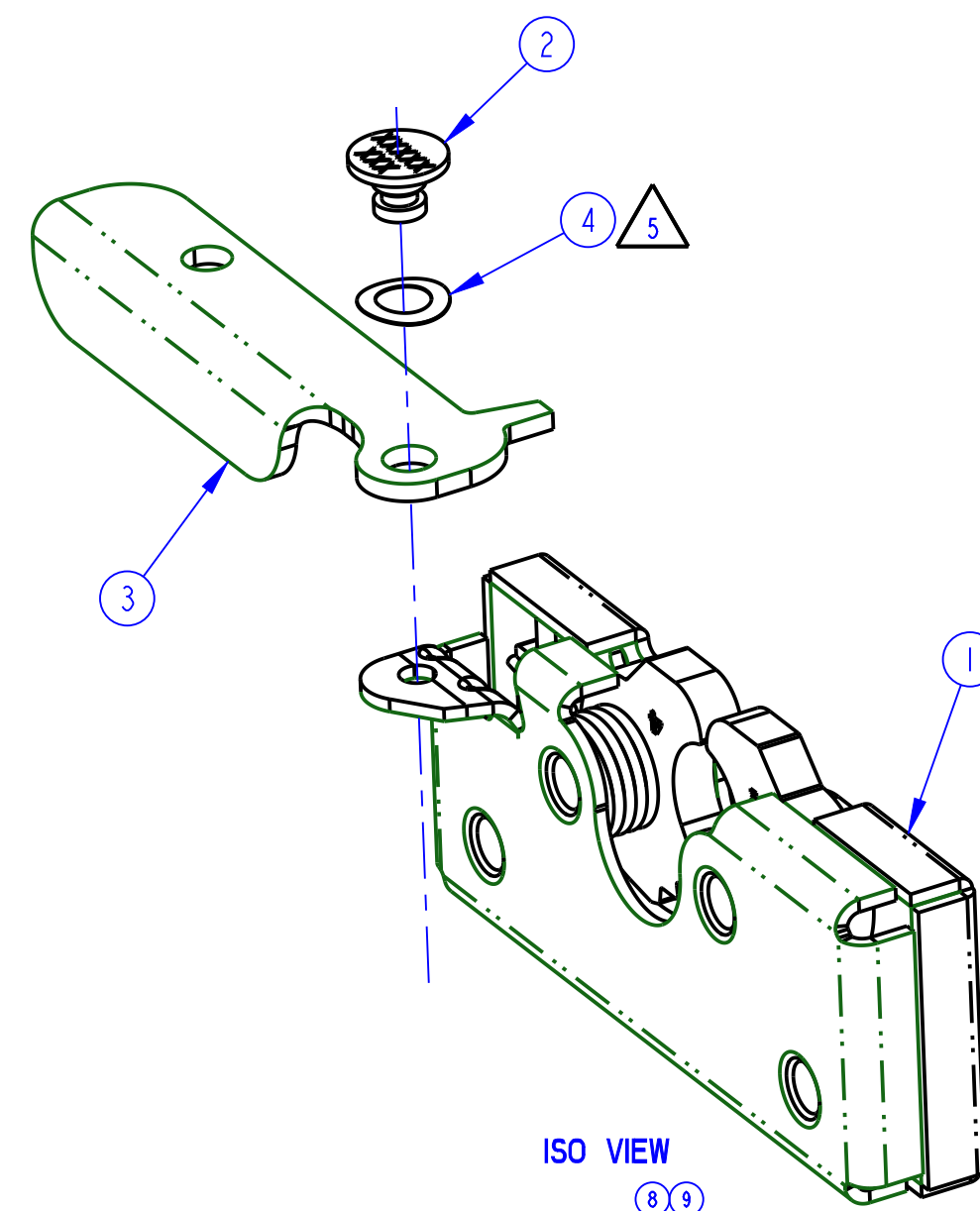
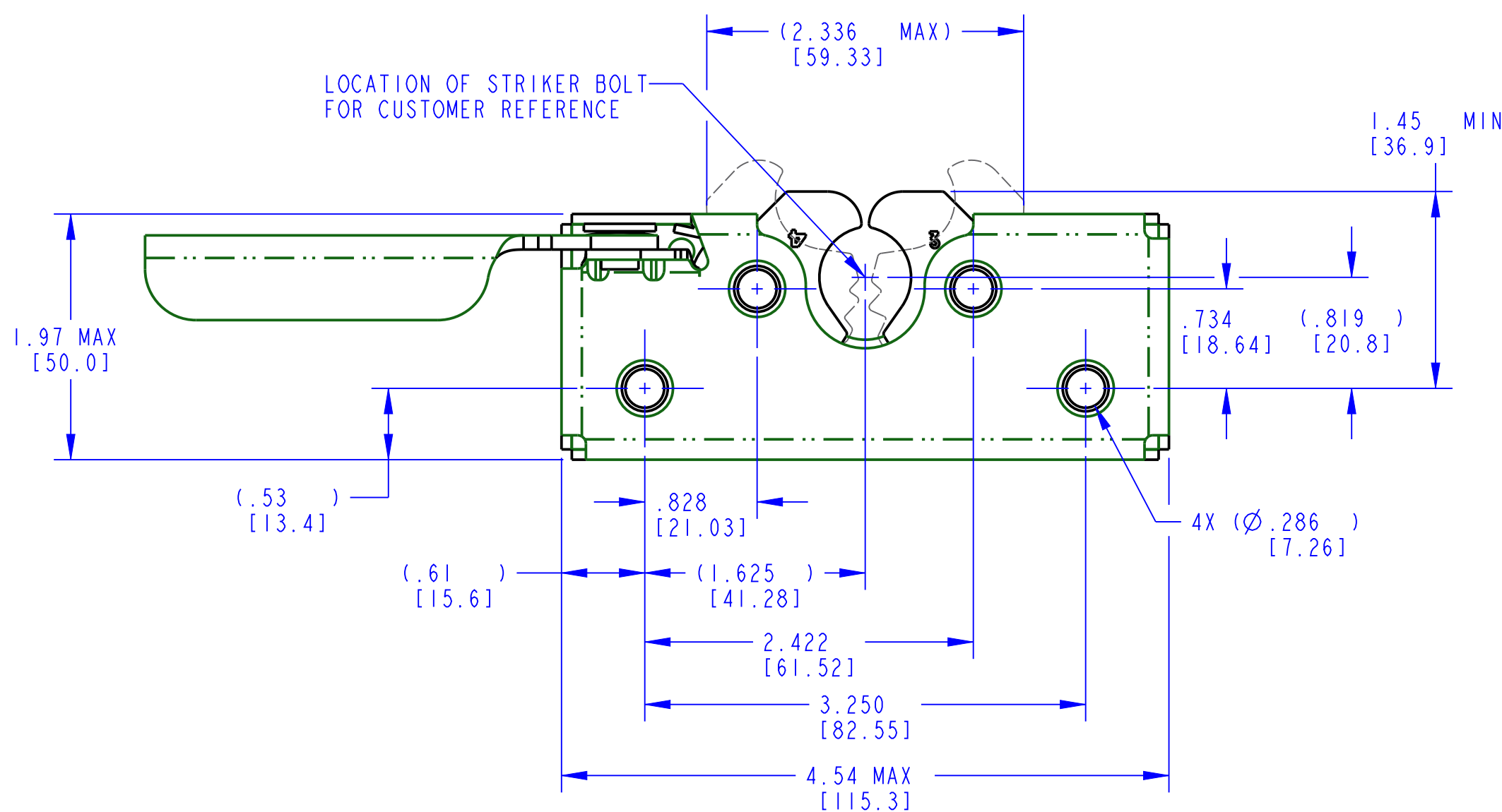
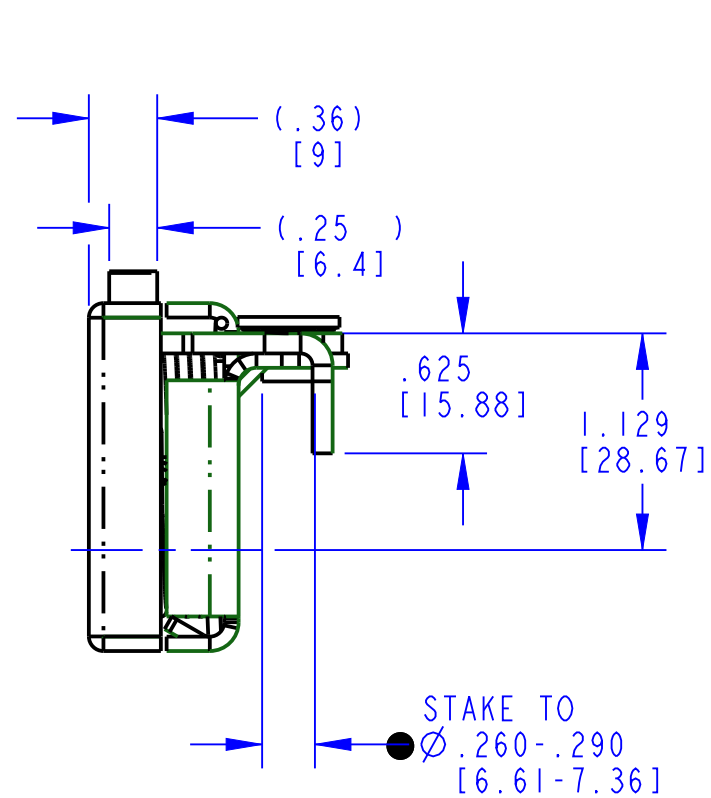
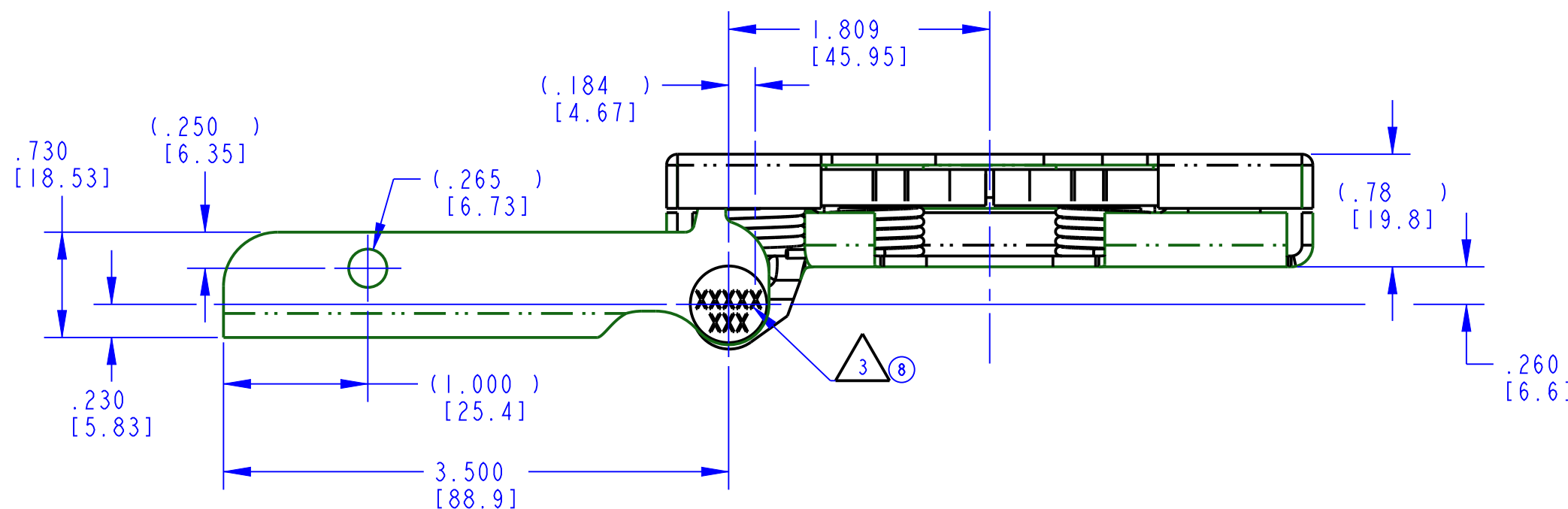

⑦⑨
NOTES: UNLESS OTHERWISE SPECIFIED;

- ⑧ 1. ASSEMBLY COMPLIES WITH STRENGTH REQUIREMENTS OF SAE STANDARD J839.
- 2. USE WITH TRI/MARK'S Ø .675 [17.15] LATCH BOLT.
- ③ IDENTIFY ASSEMBLIES WITH PART NUMBER AND DATE CODE APPROXIMATELY AS SHOWN, OR IN OTHER APPROVED LOCATIONS AS OUTLINED IN ES-121. ORIENTATION OF RIVET CONTAINING PART NUMBER AND DATE CODE NOT IMPORTANT.
- 4. DIMENSIONS IN [] ARE MILLIMETERS FOR REFERENCE ONLY.
- ⑤ WAVE WASHER MAY BE INSTALLED IN EITHER DIRECTION.
- ⑧ 6. TIGHTEN 1/4-20 GRADE 5 (OR BETTER) OR M6 X 1 CLASS 8.8 (OR BETTER) MOUNTING FASTENERS TO THE FASTENER MANUFACTURER'S RECOMMENDED TORQUE VALUE; HOWEVER, DO NOT EXCEED 120 IN-LB [13.6 Nm].

<p>● INDICATES REQUIRED ASSEMBLY INFORMATION. UOS: THE -00 VERSION SHALL BE THE UNFINISHED VERSION OF PART SHOWN. UOS: ALL DIMENSIONS APPLY BEFORE COATING. (ASME Y14.5M, sec. 2.4.1)</p>		<p>TriMark 500 Bailey Avenue P. O. Box 350 New Hampton, Iowa 50659 U.S.A. Tel: 641-394-3188 Fax: 641-394-2392</p>									
<p>TOLERANCES UNLESS OTHERWISE SPECIFIED (UOS) ASME Y14.5M-1994</p> <table border="0"> <tr> <td>INCH</td> <td>MILLIMETER</td> </tr> <tr> <td>X.X = ±.1</td> <td>X = ±.3</td> </tr> <tr> <td>X.XX = ±.03</td> <td>X.X = ±.8</td> </tr> <tr> <td>X.XXX = ±.010</td> <td>X.XX = ±.25</td> </tr> </table> <p>ANGLES X° = ±3° X.X° = ±1.0° X.XX° = ±.50°</p>		INCH	MILLIMETER	X.X = ±.1	X = ±.3	X.XX = ±.03	X.X = ±.8	X.XXX = ±.010	X.XX = ±.25	<p>DRAWN BY: KPE 07/31/87</p> <p>CHECKED BY: BAB</p>	<p>PROJECT: L86057-7</p> <p>PRODUCT CODE: E01 (050-0100)</p>
INCH	MILLIMETER										
X.X = ±.1	X = ±.3										
X.XX = ±.03	X.X = ±.8										
X.XXX = ±.010	X.XX = ±.25										
<p>DO NOT SCALE DRAWING</p>		<p>CUSTOMER PART NUMBER</p>	<p>DESCRIPTION: SEE BOM</p>								
<p>REF. T/M OP 4.20-2 FOR SUP. QUALITY REQ. REF. T/M OP 4.20-3 FOR INT. QUALITY REQ.</p>	<p>PART WEIGHT: (0.85 LB)</p>	<p>SURFACE AREA</p>	<p>SIZE: C</p> <p>SCALE: 1.0</p> <p>PART NUMBER: 11447</p>								