

PART NUMBER	ITEM 1 BRACKET (QTY)	ITEM 2 BRACKET (QTY)	ITEM 3 LEVER (QTY)	ITEM 4 BUSHING (QTY)	ITEM 5 RIVET (QTY)	⑥ PART MARKING
21375-01	21374-01 (1)	21378-01 (1)	21373-01 (1)	26580-01 (1)	23322-01 (1)	272-1623

REVISION	ECN	ECN BY	DESCRIPTION
5	14786	TAG 12JAN09	ITEM 5 WAS 20835-01, 6.05+.06/-.05 WAS 6.05+.06/-.00, 11.69/12.45 AFTER STAKING WAS Ø6.73 \5.97 AFTER STAKING
6	37419	AGG 07/20/11	ITEM 4 WAS 20828-01, ITEM 5 WAS 12843-01. UPDATED: STAKE INFO, PART MRKG.
7	37830	AGJ 06/13/12	PART MRKG 272-1623 WAS 21375.
8	38044	AGJ 10/04/12	UPDATED IMAGE OF ITEMS 1 & 2.

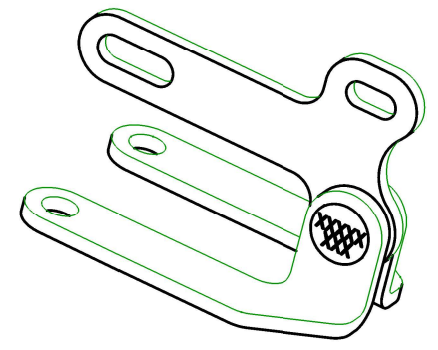
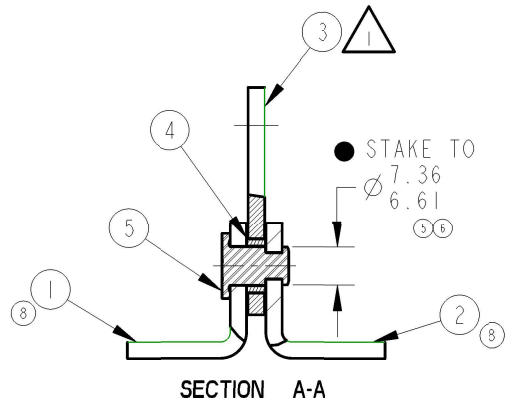
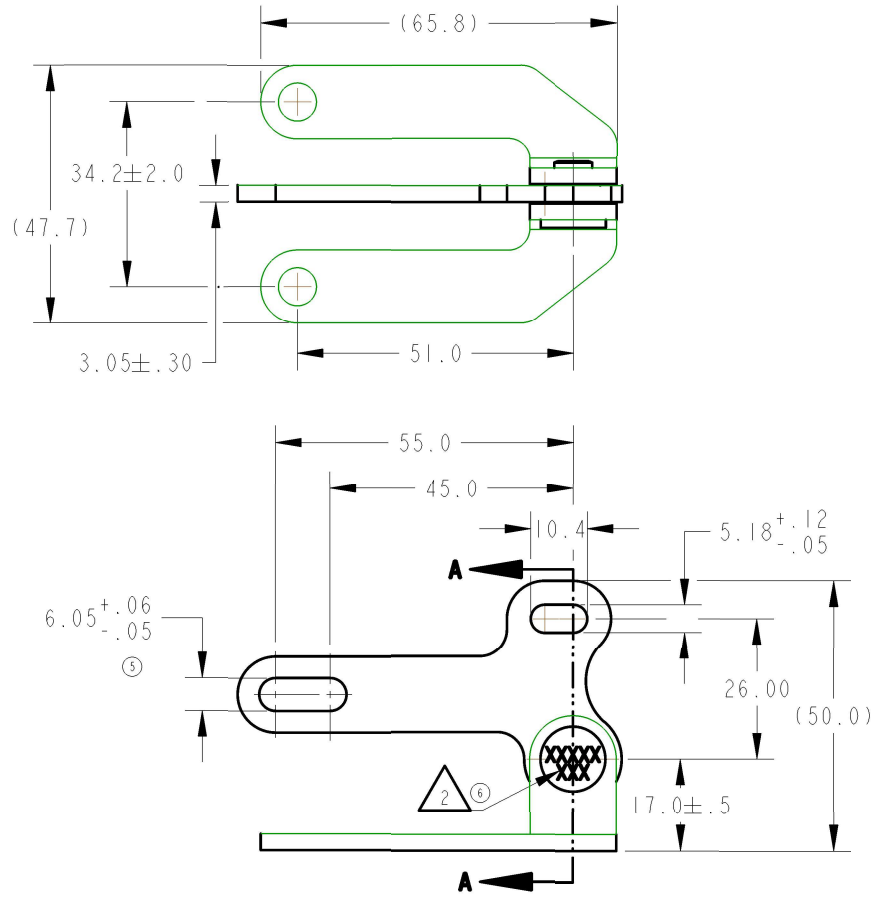

ISO VIEW

**METRIC**

NOTES: UNLESS OTHERWISE SPECIFIED;

① LEVER (ITEM 3) MUST ROTATE FREELY AFTER STAKING.

② IDENTIFY ASSEMBLY WITH PART NUMBER AND DATE CODE APPROXIMATELY AS SHOWN, OR IN OTHER APPROVED LOCATIONS AS OUTLINED IN ES-121.

<p>● INDICATES REQUIRED ASSEMBLY INFORMATION.          UOS: THE -00 VERSION SHALL BE THE UNFINISHED VERSION OF PART SHOWN.          UOS: ALL DIMENSIONS APPLY BEFORE COATING. (ASME Y14.5M-1994, sec. 2.4.1)</p>		<p><b>TriMark</b>          500 Bailey Avenue          P. O. Box 350          New Hampton, Iowa 50659 U.S.A.          Tel: 641-394-3188          Fax: 641-394-2392</p>									
<p><b>TOLERANCES UNLESS OTHERWISE SPECIFIED (UOS)</b>          ASME Y14.5M-1994</p> <table border="0"> <tr> <td>INCH</td> <td>MILLIMETER</td> </tr> <tr> <td>X.X ±.1</td> <td>X ±.3</td> </tr> <tr> <td>X.XX ±.03</td> <td>X.X ±.08</td> </tr> <tr> <td>X.XXX ±.010</td> <td>X.XX ±.25</td> </tr> </table> <p>ANGLES          X° ±3°          X.X° ±1.0°          X.XX° ±.50°</p>		INCH	MILLIMETER	X.X ±.1	X ±.3	X.XX ±.03	X.X ±.08	X.XXX ±.010	X.XX ±.25	<p>DRAWN BY: JAG 2/10/05</p> <p>CHECKED BY: GCL 7/15/05</p>	<p>PROJECT: 04049</p> <p>PRODUCT CODE: J12 (090-0201)</p>
INCH	MILLIMETER										
X.X ±.1	X ±.3										
X.XX ±.03	X.X ±.08										
X.XXX ±.010	X.XX ±.25										
<p>DO NOT SCALE DRAWING</p>		<p>CUSTOMER: CATERPILLAR</p>									
<p>REF. T/M OP 4.20-2 FOR SUP. QUALITY REQ.          REF. T/M OP 4.20-3 FOR INT. QUALITY REQ.</p>		<p>PART WEIGHT: (0.09 Kg)</p>	<p>SURFACE AREA</p>								
		<p>SIZE: B</p>	<p>SCALE: 1.0</p>								
		<p>PART NUMBER: 21375</p>									
<p>DESCRIPTION: BELLCRANK, PULL HANDLE</p>											